

INSTALLATION INSTRUCTIONS

INSTALLATION INSTRUCTIONS 2 X 2 T-BAR MOUNTING KIT MODEL TB3380A FOR USE WITH CEH/3380 SERIES HEATERS



TPI Corporation
P.O. Box 4973
Johnson City, TN
37602-4973

America's Comfort Conditioning Company

CAUTION: Disconnect supply service to avoid electrical shock.

All wiring connections must conform to the National Electric Code and local codes having jurisdiction.

NOTE: Assembly less grill and wiring compartment cover prior to placement in grid, may simplify installation.

1. Remove any part kits or packing from heater.
2. Remove the required K.O. from the ceiling box.
3. Remove wiring compartment cover if installed. Assemble heater, adapter plate and ceiling box in the order as shown. Secure the parts with the screws provided.
4. Place the above assembly in the T-bar grid.
5. Attach conduit or cable and make wiring connections and install wiring compartment cover.
6. Install grille, restore power and check heater operation (See installation sheet provided with heater).

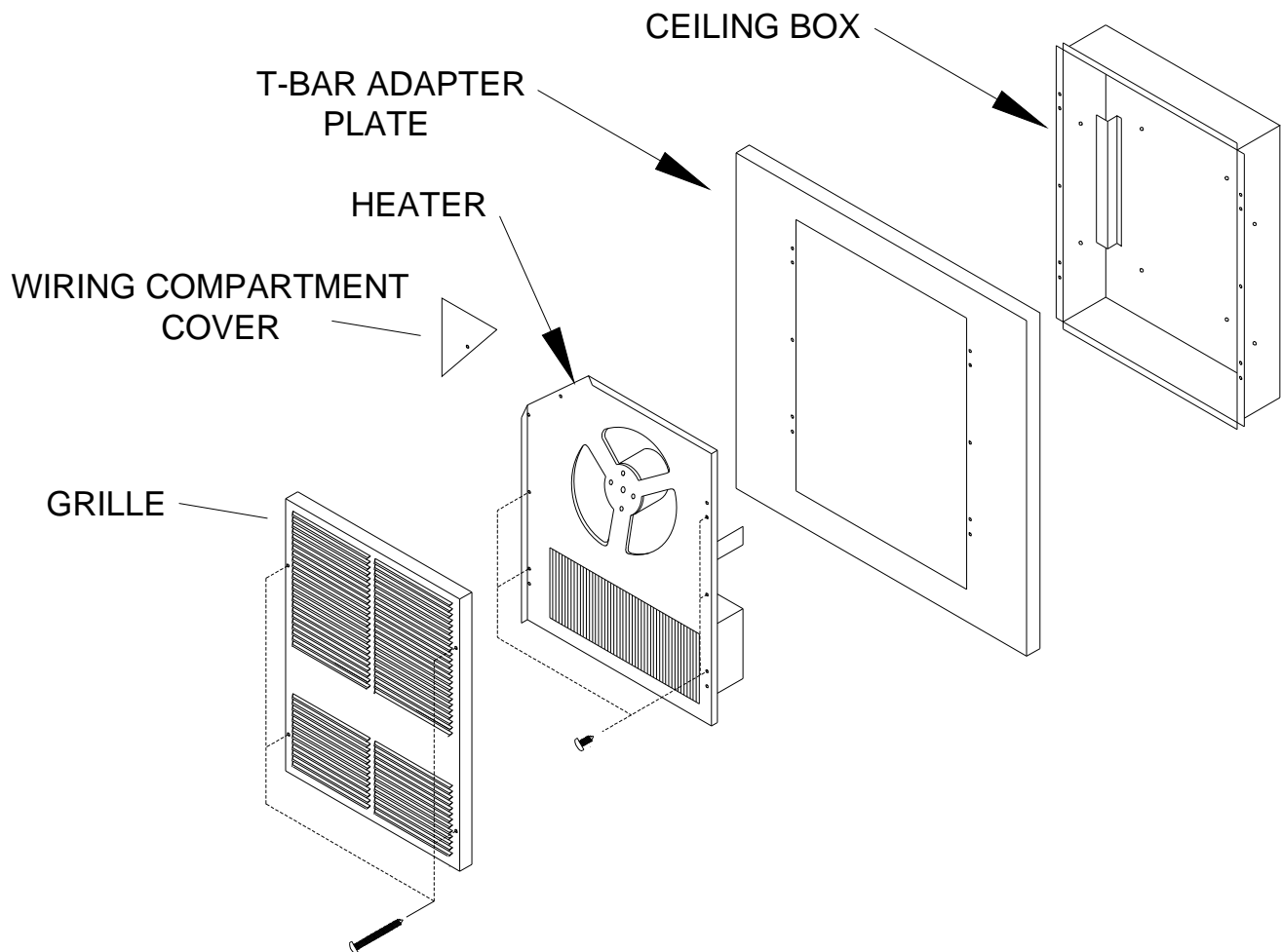

ECO 1-5757 7/07 FORM 9743

IMPORTANT: OWNER SHOULD RETAIN THESE INSTRUCTIONS FOR FUTURE REFERENCE